

Chinon

35FA Super / 35FA II

Auto Focus camera
Instruction and Illustrated manual

This camera manual library is for reference
and historical purposes, all rights reserved.

This page is copyright© by mike@butkus.org, M. Butkus, NJ.

This page may not be sold or distributed without
the expressed permission of the producer
I have no connection with any camera company.

On-line camera manual library

**If you find this manual useful,
how about a donation of \$3 to:**

M. Butkus, 29 Lake Ave.,
High Bridge, NJ 08829-1701
and send your e-mail address
so I can thank you.

Most other places would charge
you \$7.50 for a electronic copy
or \$18.00 for a hard to read Xerox copy.

This will help me to continue to host this site,
buy new manuals, and pay their shipping costs.

It'll make you feel better, won't it ?

If you use Pay Pal, use the link below.
Use the above address for a check, M.O. or cash.



www.PayPal.me/butkus

Venmo @mike-butkus-camera Ph. 2083

[Back to my main camera manual page](#)

www.butkus.us

INTRODUCTION

Welcome to the world of Chinon photography!

Your CHINON 35FA Super & 35FA 11 are one of the most advanced compact 35mm cameras available today. Employing the latest state-of-the art electronics, the CHINON 35FA Super & 35FA 11 incorporate many outstanding features such as: infrared automatic focusing, automatic loading, automatic film advance, automatic rewind and built-in flash. Other convenient features include: automatic rewind stop upon completion of rewinding, continuous exposure, 10 sec. self timer, and ASA 1000 film setting. In order to take full advantage of the many features of your CHINON 35FA Super & 35FA 11, please read this instruction manual carefully to totally familiarize yourself with the camera before actually starting to take pictures. We wish you years of satisfying and carefree photography.

NOMENCLATURE

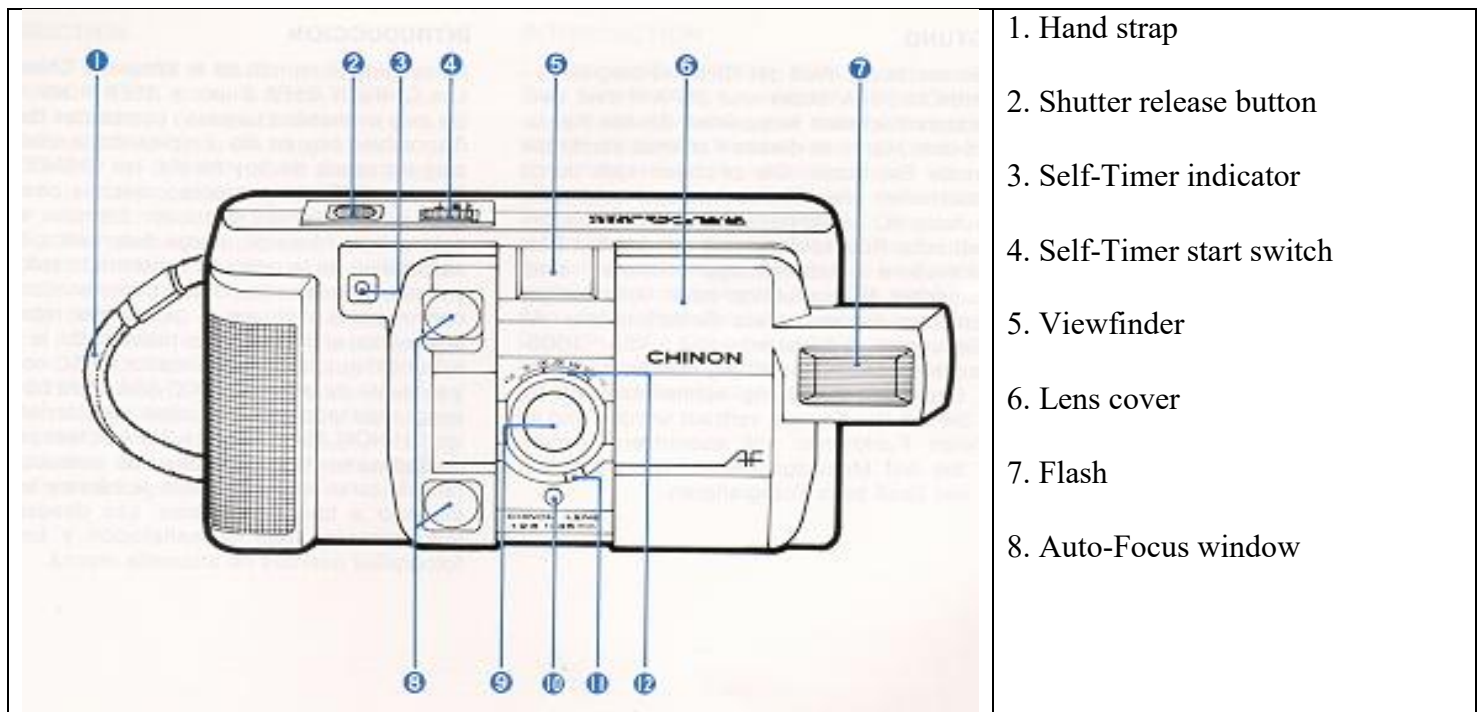

1. Hand strap
2. Shutter release button
3. Self-Timer indicator
4. Self-Timer start switch
5. Viewfinder
6. Lens cover
7. Flash
8. Auto-Focus window

9. Lens

10. Exposure metering window

11. ISO/ASA setting lever (35FA Super),
ISO/ASA setting ring (35FA II)

12. ISO/ASA scale

13. Back cover

14. Cartridge window

15. Film pressure plate

16. Flash switch

17. Flash ready indicator

18. Frame counter

19. Viewfinder eyepiece

20. Film advance indicator

21. Under exposure warning/Battery check LED

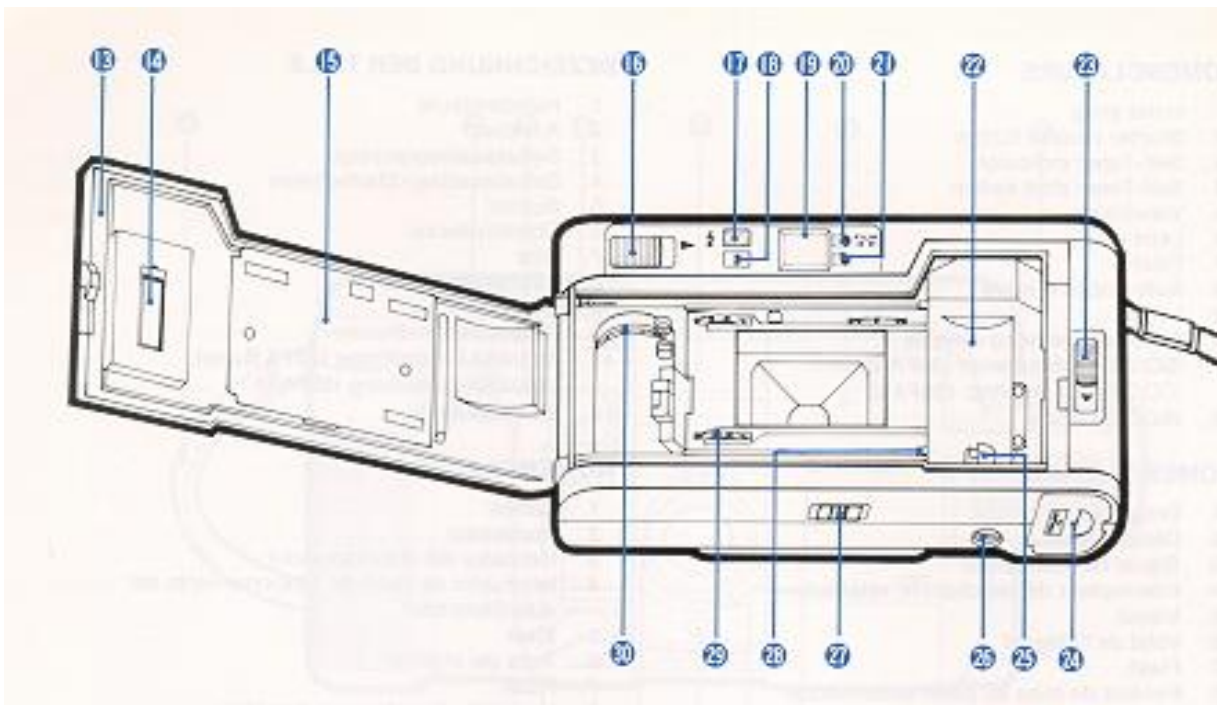

22 Film chamber

23 Back cover release button

24. Battery compartment cover

25. Rewind spindle

26. Tripod socket

27. Manual rewind switch

28. Film guide

29. Sprocket

30. Take-up spool

SPECIFICATIONS

TYPE: 35 mm EE compact Infrared Auto-Focus camera with auto film load, auto wind, auto rewind and built-in flash system.

PICTURE FORMAT: 24 x 36 mm.

LENS: 35FA Super: 35mm F2.8, 4 elements in 3 groups. 35FA 11: 35mm F3.5, 3 elements in 3 groups.

VIEWFINDER: Bright frame with AF frame, parallax marks, focus indicator (35FA Super only), under exposure warning/battery check indicator, and film advance indicator.

SHUTTER: Programmed electronic shutter (35FA Super/ EV 8-17: ASA100, 35FA 1i; EV 8.6 - 17: ASA100) with automatic lock system at low voltage.

EXPOSURE METER: SPD Automatic exposure system

ISO/ASA RANGE: 35FA Super: 50 to 400 in 1/3 EV increment plus 1000. 35FA 11:100, 200, 400 and 1000.

FOCUSING: Infrared automatic focusing system with possible prefocus and AF resuming; cancelable.

FOCUSING RANGE: 35FA Super: 1 M (3.3 ft) to infinity 35FA 11: 1.2 M (3.9 ft) to infinity.

MINIMUM AF DISTANCE WARNING: Built-in with flashing minimum AF distance mark (35FA Super only).

FILM LOADING: 35FA Super: automatically loads film and advance to the start position when the shutter release button is depressed after the camera back is closed. 35FA 11: Auto loading system by built-in motor.

FILM WIND: Automatic power winder for single frame advance and continuous exposure.

FILM REWIND: Automatic power rewinding when at end of roll of film.

INSTALLING THE BATTERIES

1. Slide the battery compartment cover in the direction of the arrow mark with your finger to open the battery compartment cover (Fig. 1).
2. Place two 1.5V "AA" size alkaline batteries (LR-6) into the battery compartment correctly so as to correspond with the positive (+) and negative (-) marks shown inside (Fig. 2).

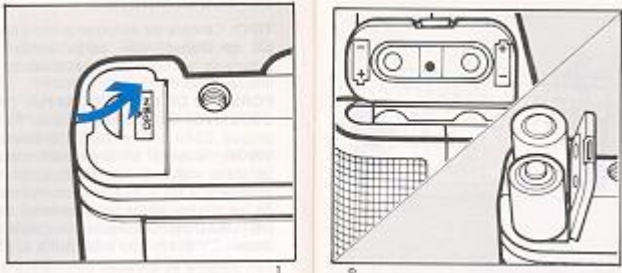

NOTE: If you do not use your camera for a long period of time, remove the batteries, and store in a dry location. This will prevent the possibility of battery leakage and damage to your camera. Do not use Ni-Cad batteries. Be sure to replace both batteries at the same time when the batteries are too weak to operate the camera.

HOW TO OPEN THE LENS COVER

1. Hold the flash unit and slide it all the way to open the lens cover (Fig. 3).
2. Slide it back in the opposite direction to close the lens cover (Fig. 4).

NOTE: All electrical circuitry is off when the lens cover is in the closed position. Even in the closed position, the power will not be off unless the winding or rewinding function is completed. The shutter will not be released unless the lens cover is fully opened.

BATTERY TESTING

1. Cover the exposure metering window with your hand and press the shutter release button halfway. (Fig. 5).
2. Make sure the under-exposure warning LED (red) blinks (Fig. 6). If the red LED fails to illuminate, the batteries are too weak and need to be replaced.

NOTE: As temperature decreases, especially below SAC, battery performance declines. Keep batteries warmed under these conditions.

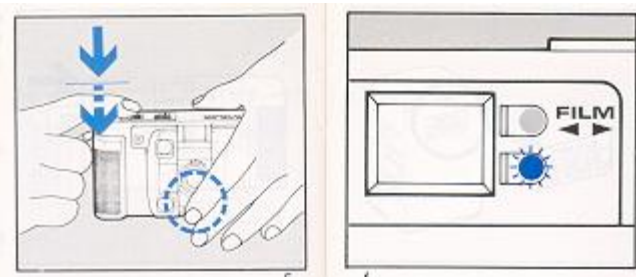

ISO/ASA SETTING

Make sure the correct ISO/ASA film speed is set on the camera to correspond with the ISO/ASA film speed indicated on the film box. Turn the ISO/ASA setting lever (setting ring) to select the desired ISO/ASA speed (Fig. 7, 8 and 9).



AUTOMATIC FILM LOADING

Always load and unload your camera in subdued light, and never in direct sunlight.

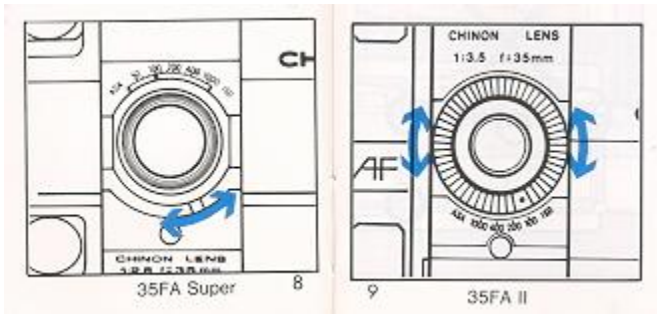

1. Depress the knob located on the back cover downward to open the back cover (Fig. 10).
2. Place the film cartridge into the chamber with the protruding end toward the top of the camera and push it in gently so that it sits firmly in the chamber (Fig. 11).

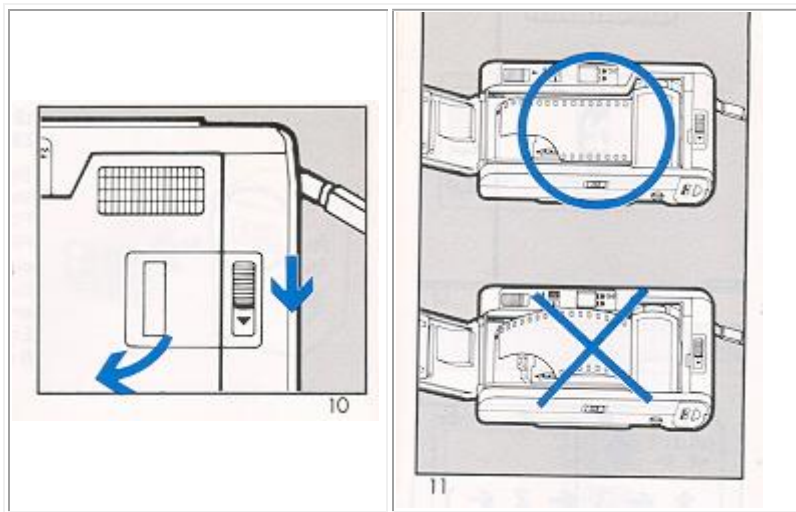

3. Place the trimmed end of the film on the take-up spool along with the arrow mark. When loading film, make sure that film lies flat between the film guides. And engage the perforation of the film with the teeth of the sprocket (Fig. 12). Then close the back cover.

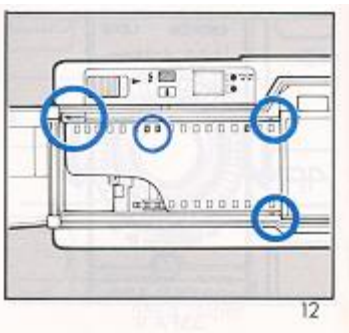

4. 35FA Super and 35FA 11 have a convenient cartridge window to confirm what type of film you are using (Fig. 13).

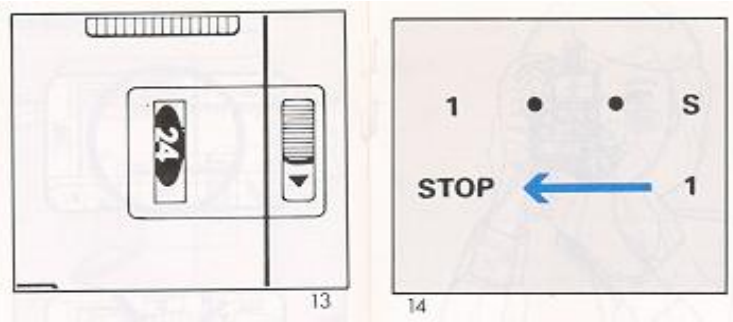

5. 35FA Super: Open the lens cover, then depress and release the shutter button. The film will automatically advance to figure "1 " position (Fig. 14). Now the film is correctly loaded, ready for the first picture. 35FA II: Open the lens cover, then depress and release the shutter button two or three times until the figure "1" appears in the frame counter for the first picture (Fig. 15).

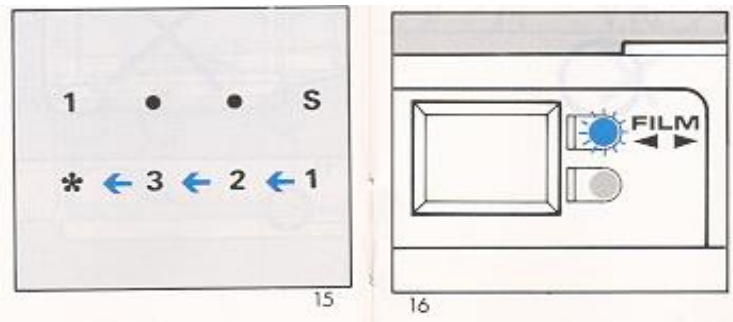

NOTE: The Film Advance Indicator blinks when the film is advancing properly (Fig. 16). If it does not blink, reload the film.

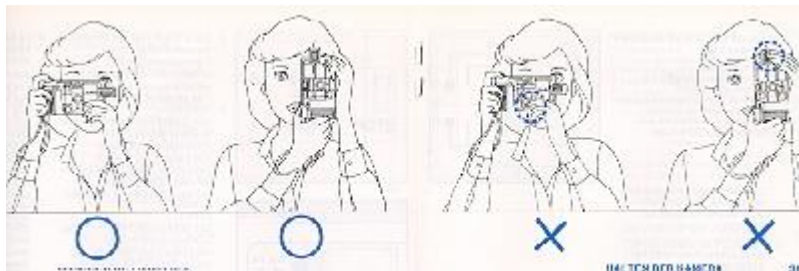

Proper ways and improper ways to hold you camera.

AUTO-FOCUS SHOOTING

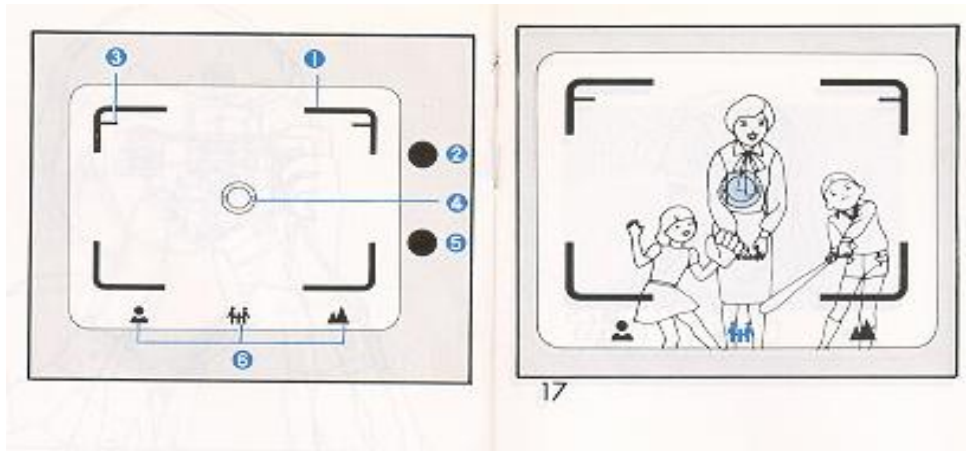

1. Bright Line Frame
2. Film Advance Indicator
3. Parallax Marks
4. Auto-Focus Frame
5. Under Exposure Warning/ Battery Check LED
6. Symbol Marks (35FA Super only)

1. Look through the viewfinder and compose the picture so that the main subject is placed in the auto focus frame (4) (Fig. 17).

2. Gently press the shutter release button halfway. With the 35FA Super, the approximate distance from the camera to the subject is indicated on the symbol mark scale (6) in the viewfinder.

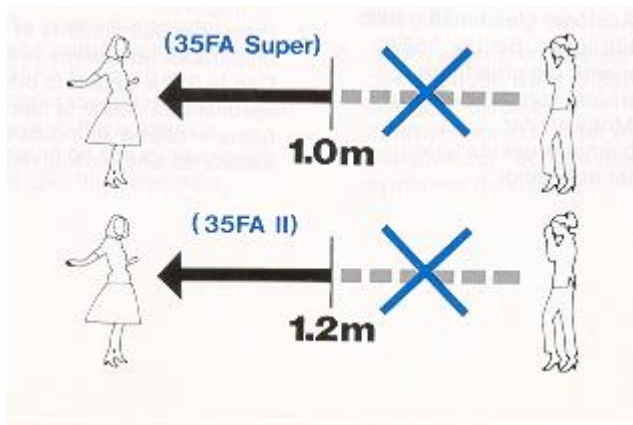

3. When taking a picture closer than 1.5 meters (5 feet) or when the · mark lights up (35FA Super), the image area is indicated by parallax marks 3 in the top left and top right corners of the viewfinder. Compose the photograph within the imaginary zone extending from the corner of the parallax marks (Fig. 18).



NOTE: If the (person) mark blinks, the subject is too close to be focused.

4. Press the shutter release button all the way and, lift your finger off the release button. When the under exposure warning LED (5) lights up, use flash.

NOTE: The following subjects will not be properly auto-focused:

- Shiny subjects such as water surfaces or the exterior of a car body.
- Subjects through a glass window
- Semi-reflective subjects.

CONTINUOUS SHOOTING

With your Chinon 35FA Super & 35FA 11, you can continuously shoot pictures as long as the shutter is fully depressed.

NOTE: Continuous shooting may not be possible if the batteries are too weak.



FOCUS LOCK SYSTEM

This feature may be used to eliminate tricky focusing situations such as the main subject located "off center" in the viewfinder. In such a situation, first focus on the main subject (by placing the subject in the AF frame) and depress the shutter release button halfway. Hold the shutter release button in the halfway position and recompose the subjects in the viewfinder, then depress the shutter release button fully. This focus lock system is cancelable by removing your finger from the release button.



FILM REWINDING

1. When the roll of film is completed, the camera automatically rewinds the film. During rewinding, the film advance indicator blinks indicating proper rewinding (Fig. 19)

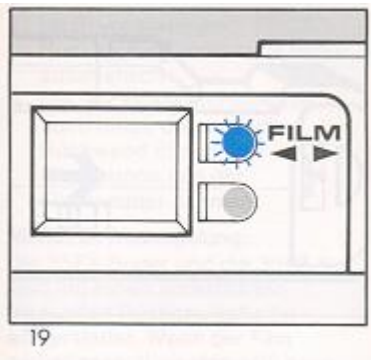

2. When the rewinding is completed, motor will stop automatically.

3. Push the back cover release button down, open the back cover, and remove the film cartridge from the film chamber

Manual Rewind: 35FA Super and 35FA 11 are equipped with a convenient manual rewind switch. When you desire to rewind the film before it has been fully exposed, slide the manual rewind switch in the direction of the arrow (Fig. 20). When the batteries are weak, film may not be automatically rewound. In that case, replace the batteries with new ones, then use the manual rewind switch.

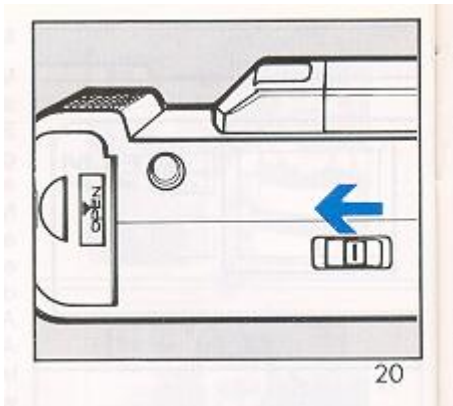

NOTE: The camera will not operate if the manual rewind switch is activated when there is no film in the camera. To operate the camera, open the back cover to deactivate the rewind switch.

FLASH PHOTOGRAPHY

Switch to flash photography when the under exposure warning LED blinks during pressing the shutter release button halfway (Fig. 21).

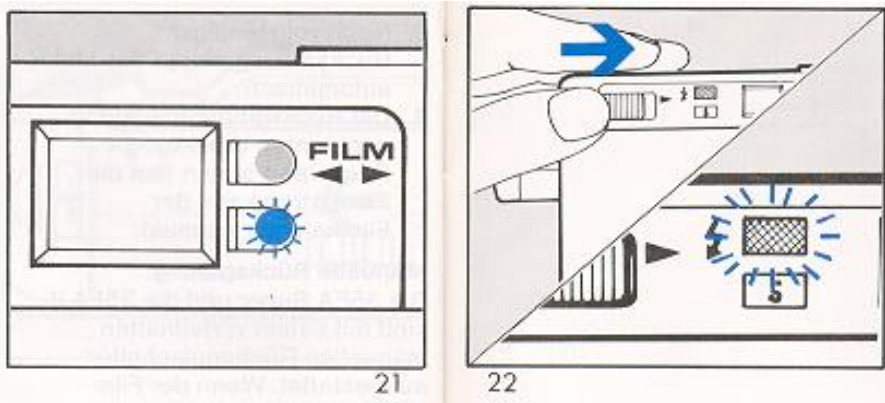

1. Slide the Flash Switch in the direction of the arrow.

2. Make sure that the Flash Ready Indicator is illuminated, then shoot (Fig. 22). - When the flash photography is completed, slide the Flash Switch in the direction of the arrow (Fig. 23). The Flash Switch can automatically return to the OFF position by closing the lens cover.

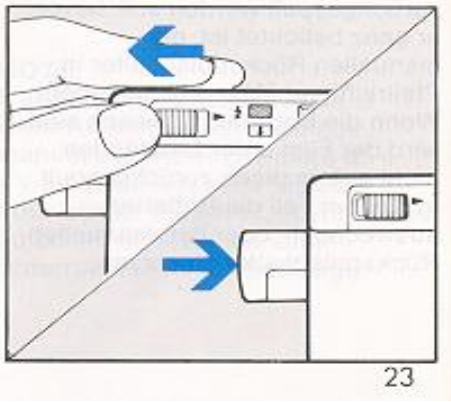

NOTE: Even if the flash ready indicator illuminates, actual shutter release will only occur with a fresh set of batteries. To check the strength of the batteries, slightly press the shutter release button while covering the exposure meter window. The batteries are OK if the under exposure warning LED blinks during this testing procedure. If the under exposure warning LED does not blink, this is an indication that your batteries are weak and should be replaced immediately.

ASA	35FA Super	35FA II
50	1 - 3m (3.3- 10ft.)	-
100	1 - 4.2m (3.3 - 14ft)	1.2 - 3.4m (3.9 - 11ft)
200	1 - 6m (3.3 - 20ft)	1.2 - 4.8m (3.9 - 16ft)
400	1.5 - 6.4m (5 - 21ft)	1.5 - 6m (5 - 20ft)
1000	2 - 11m (6.6 - 36ft)	2 - 9m (6.6 - 30ft)

NOTES:

1. The Flash Switch can not be operated when the lens cover is closed.
2. If you release the shutter before the Flash Ready Indicator glows, exposure will not be correct.
3. Do not continuously press the shutter release button halfway while waiting for the flash ready indicator to illuminate, since the flash will not charge.

DAYLIGHT FLASH PHOTOGRAPHY

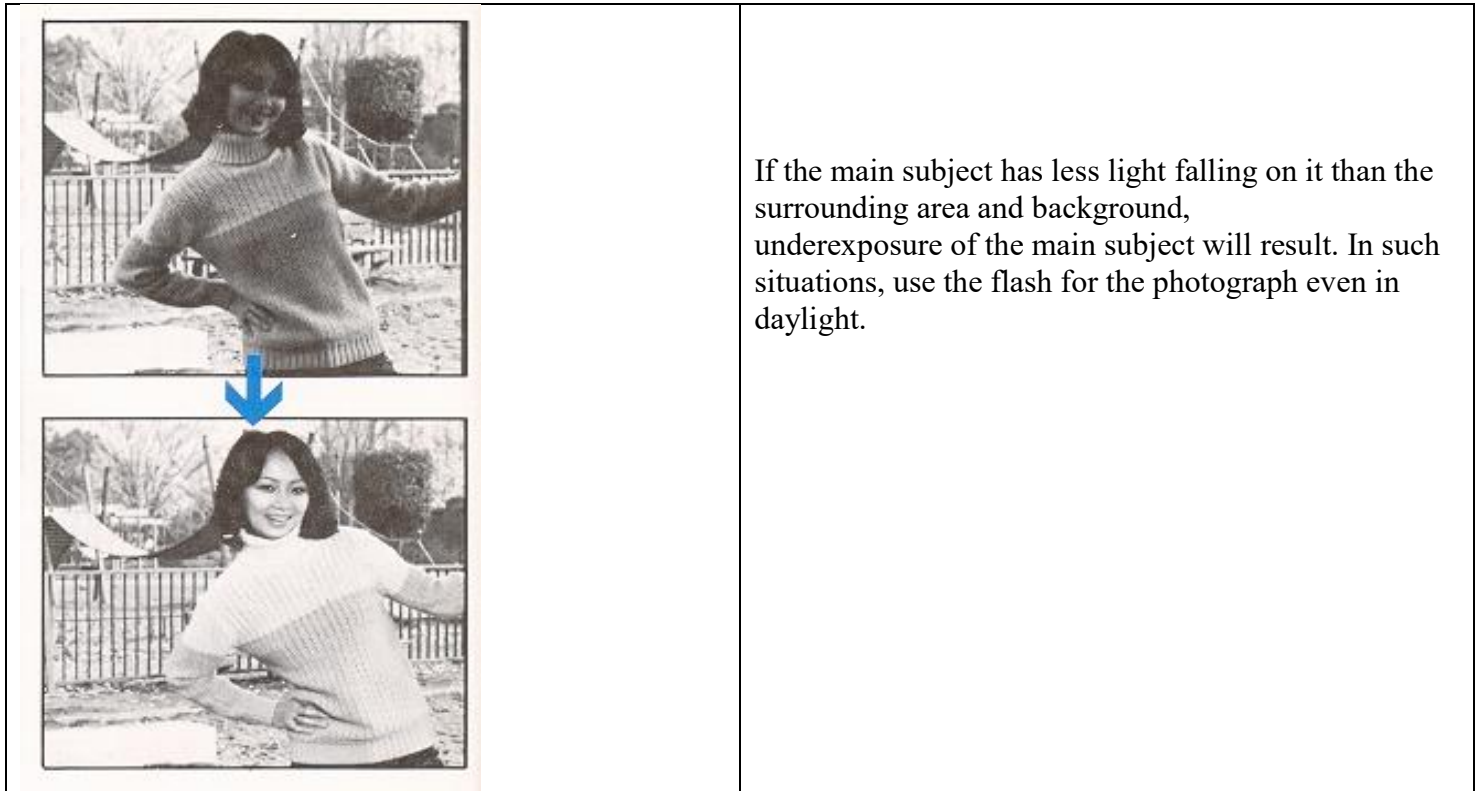

SELF-TIMER

1. Place the camera on a tripod or other firm support.
2. After you check the exposure and adjust the focus simply slide the Self-Timer Switch in the direction of the arrow and withdraw your finger (Fig. 24). The picture will be taken in approximately 10 seconds.

You will notice the red LED Self

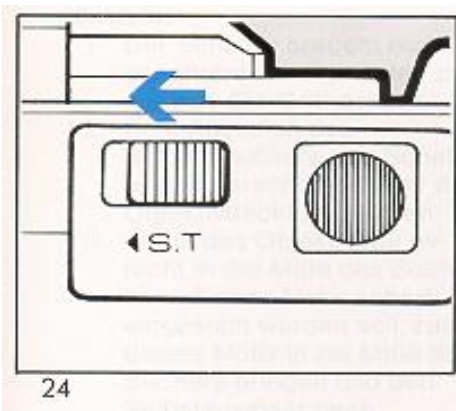

Timer indicator blinking. Two seconds before the shutter is released the flashing frequency will increase, giving you or your subject a visual signal that the shutter is about to be released.

NOTE:

1. You need not to slide and hold the switch. Just one-touch will do.
2. If you want to cancel the Self Timer, slide the switch again or close the lens cover.
3. If you desire to focus the subject located "off center" in' the viewfinder, first position the subject in the center of the viewfinder and start the Self-Timer, then recompose your picture.
4. When using with the flash, make sure that the Flash Ready Indicator lights up before taking picture.

CARE OF THE CAMERA

Your Chinon 35FA Super & 35FA 11 are precision instruments. When used with care it will provide years of trouble-free service. Protect your camera from dirt, rain, dampness and excessive heat. Avoid touching the lens. To clean the lens, wipe it gently with a soft lintless cloth or tissue. Do not use eyeglass tissues as they might damage the lens coating. Do not open and touch the inside of camera as the high voltage in the flash circuit is dangerous.